

Thank you for purchasing this Dynojet kit. This kit has been developed for a motorcycle which is set to the parameters listed at the right in the "Stage" description. If your motorcycle does not meet any of these parameters please check with Dynojet before installation. For technical assistance contact your Dynojet distributor or call Dynojet U.S.A. (800)-992-4993



WARNING

**NO SMOKING!
NO OPEN FLAME!
WHILE INSTALLING
YOUR DYNOJET KIT**

2191 Mendenhall Dr. Suite 105
North Las Vegas, NV 89081
TEL: 702-399-1423
FAX: 702-399-1431
8am-5pm Pacific Time
Monday through Friday

Website Address
<http://www.dynojet.com>

The manufacturer and seller make no warranties express or implied which extend beyond the description of the goods contained herein. Any description of this product is for the purpose of identifying it and shall not be deemed to create an express warranty.

2188.001
U.S Models Only
2000-2002 Kawasaki ZX-6R
Stage 1

For mildly tuned machines using the stock airbox, with stock or K&N filter. May also be used with a good aftermarket exhaust system

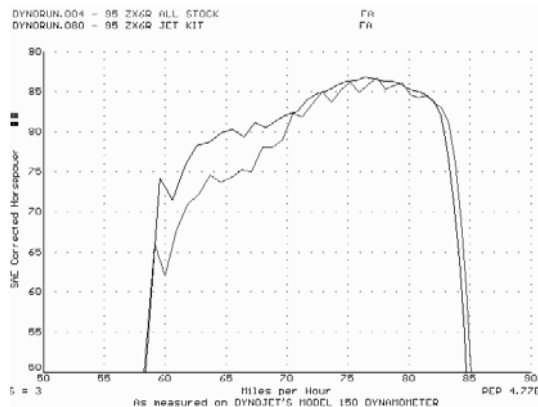

This graph shows a typical gain with a Dynojet jet kit.

Parts List		
2	Main Jets	DJ112
2	Main Jets	DJ114
2	Main Jets	DJ116
2	Main Jets	DJ118
2	Main Jets	DJ120
2	Main Jets	DJ122
4	Fuel Needles	DNO261
4	E-Clips	DE0001
4	Adjusting Washers	DW0001
4	Main Air Plugs	DCO500
4	Needle Springs	DSP77
1	Tool	DT001
1	Plug Drill	DD 5/32
1	Screw	DS0001

STAGE ONE INSTRUCTIONS

Dynojet

2188.001

1. Remove vacuum slides from carbs. Remove stock needles and spacers, noting order of assembly (Fig.A).
2. Install the Dynojet needles on groove #3 from the top. Use all stock spacers (Fig. A). The small Dynojet washers are for half step increments and do not have to be installed at this time. **NOTE: The DSP77 springs do not have to be used, they are supplied in case the stock springs are misplaced.** After installing the slides in the carbs be sure to check slide movement manually.
3. Locate the stock main jet under the float bowl on the bottom of the carbs (Fig. C). Remove the stock main jets and replace with the Dynojet main jets provided. If you are running the stock exhaust install the DJ114 main jets in the outside cylinders and DJ116 main jets in the inner cylinders. If you are running an aftermarket exhaust with wide open baffles use the DJ118 main jets in the outside cylinders and the DJ120 main jets in the inner cylinders. Be sure that the jet you are changing is the main jet.
4. Locate the main air jet passage (Fig. B). Install the main air jet plugs (DCO500) into the main air jet passage with the flat end facing into the carb. Use the tool provided (DT001) to lightly tap into place.
5. Locate the fuel mixture plug (Fig. C). If you see a screw head at Fig. C then proceed to the adjusting procedure. With the 5/32 drill bit provided carefully drill through the plug. **NOTE: The mixture screw is directly underneath this plug, be ready to pull back on the drill the instant you break through.** Use screw provided to secure and remove this plug. Carefully turn the mixture screws clockwise until lightly seated, then back out 3 turns.

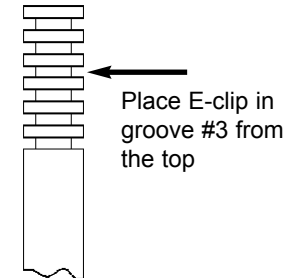

Fig. A

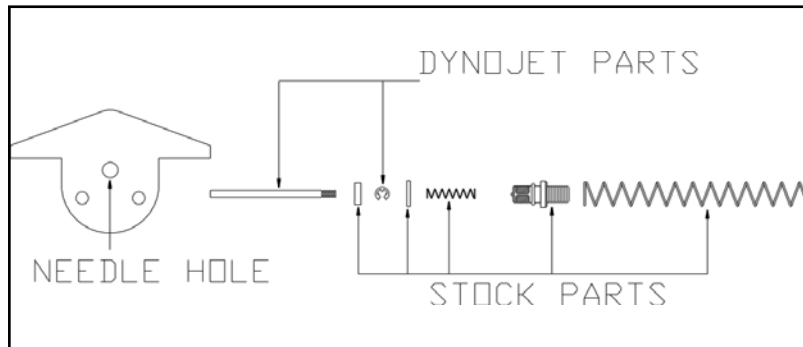

Fig. B

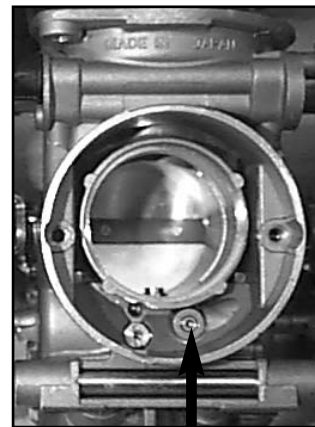

Fig. C

