

Thank you for purchasing this Dynojet kit. This kit has been developed for a motorcycle which is set to the parameters listed at the right in the "Stage" description. If your motorcycle does not meet any of these parameters please check with Dynojet before installation. For technical assistance contact your Dynojet distributor or call Dynojet U.S.A. (800)-992-4993

2191 Mendenhall Dr. Suite 105
 North Las Vegas, NV 89031
 TEL: 702-399-1423
 FAX: 702-399-1431
 8am-5pm Pacific Time
 Monday through Friday

Website Address
<http://www.dynojet.com>

The manufacturer and seller make no warranties express or implied which extend beyond the description of the goods contained herein. Any description of this product is for the purpose of identifying it and shall not be deemed to create an express warranty.



3142.001

U.S Models Only

1991-93 Suzuki GSX1100G

Stage 1

For mildly tuned machines using the stock airbox, with stock filter. May also be used with a good aftermarket exhaust system
 K&N filter #N/A

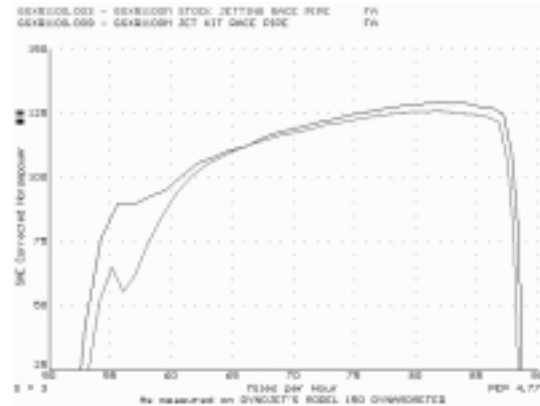

This graph shows a typical gain with a Dynojet jet kit.

WARNING

**NO SMOKING!
 NO OPEN FLAME!
 WHILE INSTALLING
 YOUR DYNOJET KIT**

Parts List

4	Main Jets	DJ110
4	Main Jets	DJ114
4	Fuel Needles	DNO332
4	Adjusting Washers	DW0001
4	E-Clips	DE0001
4	Emulsion Tubes	DET002
1	Drill	DD #32
1	Plug Drill	DD #5/32
1	Screw	DS0001

STAGE ONE INSTRUCTIONS

1. Remove the vacuum slide from the carbs. Remove the stock needles & spacers, noting the order of assembly.
2. Remove the main jet, tap lightly on the emulsion tube to push into carb venturi. Install the Dynojet emulsion tube into the carbs (Fig. B)
3. Install the Dynojet main jets provided. Use the DJ110 main jets with stock exhaust pipe, or use the DJ114 main jets with aftermarket header or slip-on with high flowing baffles. Be sure that the jets you are changing are the main jets.
4. Install the Dynojet needles on groove #2, you must use the DD #32 drill bit to enlarge the stock needle spacer. We apologize for the inconvenience but this will not affect going back to stock at a later date. Using all stock spacers (Fig. A), install the Dynojet washer above the E-clip.
5. Locate the Fuel Mixture Plug (Fig. C), if you see a screw head, proceed to adjusting procedure. With the 5/32 drill provided, carefully drill thru the plugs. NOTE: the mixture screw is directly underneath this plug, be ready to pull back on the drill the instant you break thru. Use screw provided to secure and remove the plug. Carefully turn mixture screw clockwise until seated, then back out 2-1/4 turns.

DYNOJET

3142.001

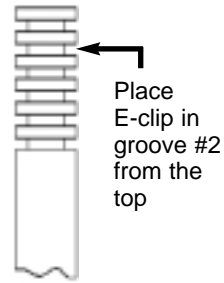

Fig. C

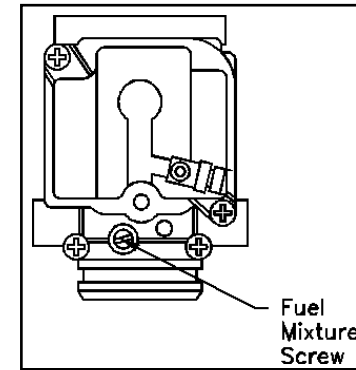

Fig. A

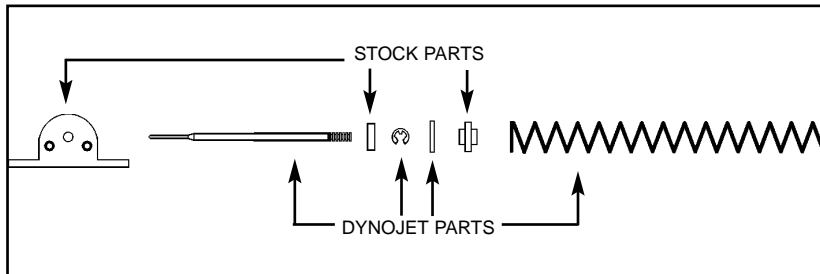

Fig. B

