

Thank you for purchasing this Dynojet kit. This kit has been developed for a motorcycle which is set to the parameters listed at the right in the "Stage" description. If your motorcycle does not meet any of these parameters, please check with Dynojet before installation. For technical assistance contact your Dynojet distributor or call Dynojet U.S.A. (800)-992-4993

2191 Mendenhall Dr. Suite 105  
 North Las Vegas, NV 89081  
 TEL: 702-399-1423  
 FAX: 702-399-1431  
 8am-5pm Pacific Time  
 Monday through Friday

Website Address  
<http://www.dynojet.com>

The manufacturer and seller make no warranties express or implied which extend beyond the description of the goods contained herein. Any description of this product is for the purpose of identifying it and shall not be deemed to create an express warranty.



4168.002

U.S. Models Only

1998-2013 Yamaha XVS650 V-Star

**Stage 1**

For mildly tuned machines using the stock airbox with stock or K&N filter. May also be used with a good aftermarket exhaust system  
 K&N filter #YA-0085

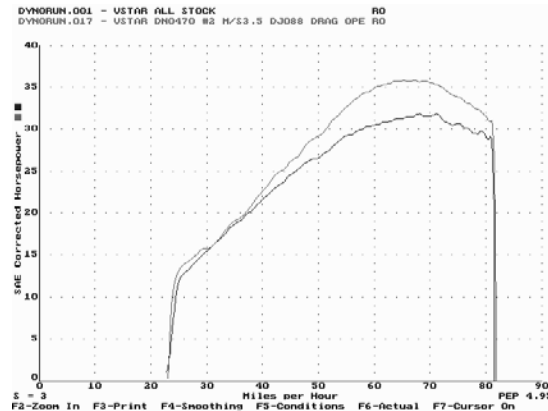

This graph shows a typical gain with a Dynojet jet kit.

**WARNING**  
**NO SMOKING!**  
**NO OPEN FLAME!**  
**WHILE INSTALLING**  
**YOUR DYNOJET KIT**

<b>Parts List</b>		
2	Main Jets	CJ086
2	Main Jets	CJ090
2	Fuel Needles	DNO470
2	E-clips	DE0001
2	Adjusting Washers	DW0001
1	Plug Drill	DD 5/32
1	Screw	DS0001

## STAGE ONE INSTRUCTIONS

**Dynojet**

**4168.002**

1. Remove the vacuum slides from the carbs. Remove stock needles and spacers noting order of assembly (Fig.A).
2. Install Dynojet needles on groove #3. Use all stock spacers (Fig. A). Install the Dynojet washers above the e-clip.
3. Remove the stock main jets and replace with the Dynojet main jets provided. If you are running the stock exhaust use the CJ086 main jets. If you are running an aftermarket exhaust or slip-on with high flowing baffles, use the CJ090 main jets. Be sure that the jet you are changing is the main jet.
4. Locate the fuel mixture plug (Fig. B), if you see a screw head at Fig. B proceed to the adjusting procedure. With the DD #5/32 drill provided, carefully drill through the plug. **NOTE: The mixture screw is directly underneath this plug, be ready to pull back on the drill the instant you break through.** Use screw provided to secure and remove this plug. Carefully turn mixture screw in until lightly seated, then back out 3 turns.

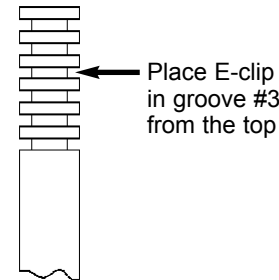

Fig. A

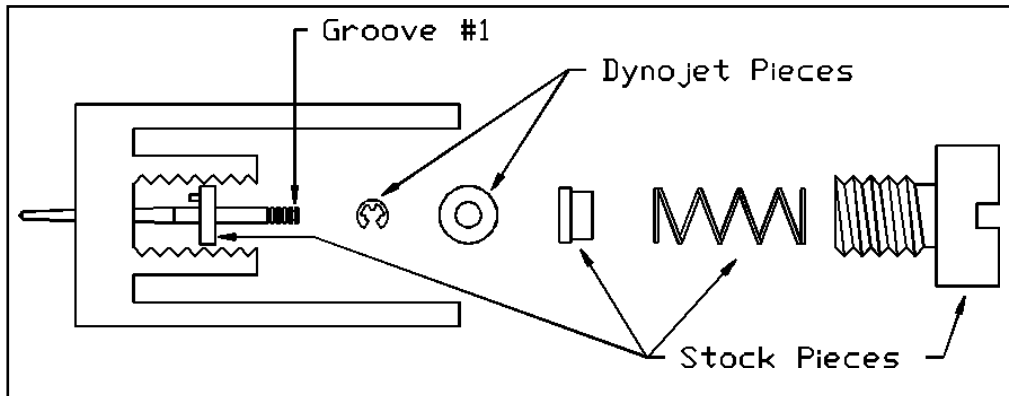

Fig. B

