

# Q420.001

## 2003~2006 Yamaha

### 450 Kodiak Auto

### Stage 1

For mildly tuned machines using the stock airbox with stock or aftermarket filter. May also be used with a good aftermarket exhaust system.

K&N Filter # N/A

<b><i>Parts List</i></b>		
1	Main Jet	DJ116
1	Main Jet	DJ118
1	Main Jet	DJ120
1	Main Jet	DJ122
1	Main Jet	DJ124
1	Main Jet	DJ126
1	Main Jet	DJ128
1	Main Jet	DJ130
1	Fuel Needle	DNO490
1	Slide Spring	DSP011
1	Needle Spring	DSP77
1	Adjusting Washer	DW0001
1	E-Clip	DE0001

## STAGE ONE INSTRUCTIONS

1. Remove vacuum slide from carb. Remove stock needle & spacers, noting order of assembly (Fig.A).
2. Install Dynojet needle on groove #4 for applications below 5000 feet, groove #3 for above 5000 feet, using all stock spacers (Fig.A). Install the Dynojet slide spring (DSP011) in place of the stock slide spring. **NOTE:** The DSP77 spring does not have to be used, it is supplied in case the stock spring is misplaced. The Dynojet washer (DW0001) does not need to be installed at this time, it is for half step adjustments. After installing the slides in the carbs be sure to check slide movement manually before air box installation.
3. Remove stock main jet and replace with Dynojet main jet provided. Use the DJ124 below 3000 feet, DJ120 from 3000 to 6000 feet and DJ116 above 6000 feet. When using an aftermarket exhaust with a high flow baffle, Use the DJ128 below 3000 feet, DJ124 from 3000 to 6000 feet and the DJ120 above 6000 feet.
4. Locate the Fuel Mixture Screw (Fig.B). Using a flat blade screwdriver, turn the mixture screw clockwise until it seats, then turn out 2.5 turns, 2 turns above 5000 feet.

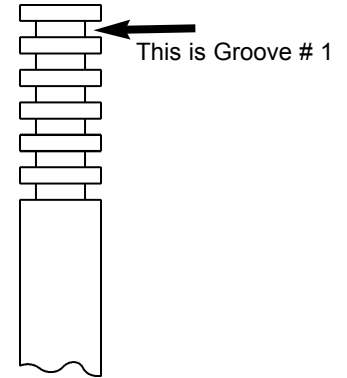

Fig.A

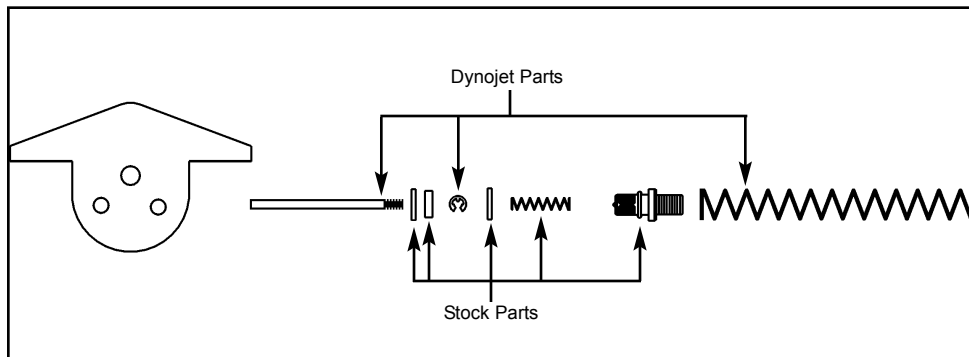

Fig.B

