

Q425.001

2004~2007 Yamaha

660 Rhino

Stage 1

For mildly tuned machines using the stock airbox with stock or aftermarket filter. May also be used with a good aftermarket exhaust system.

<i>Parts List</i>		
1	Main Jet	DJ142
1	Main Jet	DJ146
1	Main Jet	DJ150
1	Main Jet	DJ155
1	Main Jet	DJ160
1	Main Jet	DJ165
1	Main Jet	DJ170
1	Main Jet	DJ175
1	Fuel Needle	DNO750
1	Slide Spring	DSP026
1	Needle Spring	DSP77
1	Adjusting Washer	DW0001
1	E-Clip	DE0001
1	Plug Screw	DS0001
1	Plug Drill	DD 5/32

STAGE ONE INSTRUCTIONS

1. Remove vacuum slide from carb. Remove stock needle & spacers, noting order of assembly (Fig.A).
2. Install Dynojet needle on groove #2 for applications below 5000 feet, groove #1 for above 5000 feet, using all stock spacers (Fig.A). Install the Dynojet slide spring (DSP026) in place of the stock slide spring. **NOTE:** *The DSP77 spring does not have to be used, it is supplied in case the stock spring is misplaced.* The Dynojet washer (DW0001) does not need to be installed at this time, it is for half step adjustments. After installing the slides in the carbs be sure to check slide movement manually before airbox installation.
3. Remove stock main jet and replace with Dynojet main jet provided. Use the DJ155 below 3000 feet, DJ150 from 3000 to 6000 feet and DJ146 above 6000 feet. When using an aftermarket exhaust with a **HIGH FLOW** baffle, use the DJ165 below 3000 feet, DJ160 from 3000 to 6000 feet and the DJ155 above 6000 feet.
4. Locate the Fuel Mixture Screw (Fig.B). If you see a screw head at Fig. B then proceed to the adjusting procedure. If there is a plug at Fig B use 5/32 drill bit provided carefully drill through the plug. **NOTE:** *The mixture screw is directly underneath this plug, be ready to pull back on the drill the instant you break through.* Use screw provided to secure and remove this plug. Using a flat blade screwdriver, turn the mixture screw clockwise until it seats, then turn out 2 turns below 3000 feet or 1.5 turn above 3000 feet.

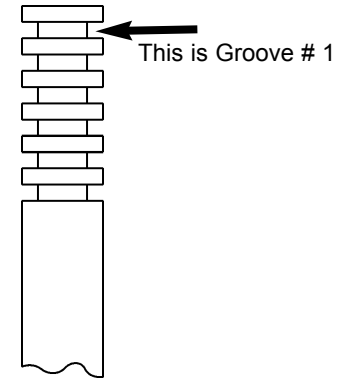

Fig.A

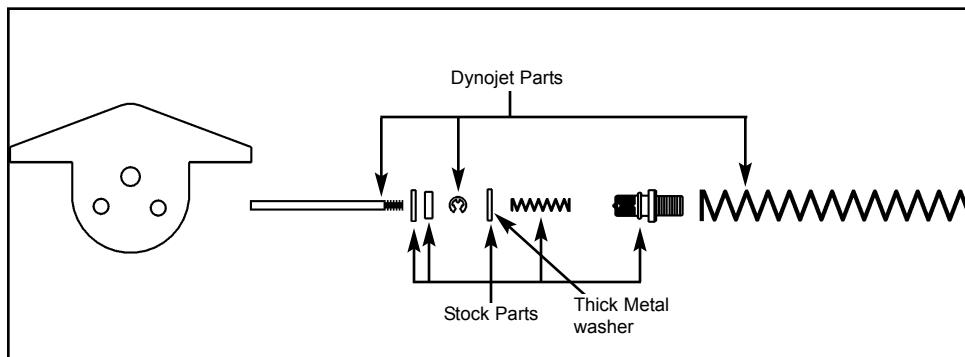

Fig.B

