

Q438.001

2012-2013 Yamaha

YFZ450

Stage 1

For mildly tuned machines using the stock airbox with stock or aftermarket filter. May also be used with a good aftermarket exhaust system.

<i>Parts List</i>		
1	Main Jet	DJ142
1	Main Jet	DJ146
1	Main Jet	DJ150
1	Main Jet	DJ155
1	Main Jet	DJ160
1	Main Jet	DJ165
1	Fuel Needle	DNO709
1	Slide Spring	DSP026
1	Needle Spring	DSP77
1	Adjusting Washer	DW0001
1	E-Clip	DE0001
1	Plug Drill	DD 5/32
1	Screw	DS0001

STAGE ONE INSTRUCTIONS

Q438.001

1. Remove vacuum slide from carb. Remove stock needle & spacers, noting order of assembly (Fig.A).
2. Install Dynojet needle on groove #4 for applications below 5000 feet, groove #3 for above 5000 feet, using all stock spacers (Fig.A). Install the Dynojet slide spring DSP026 in place of the stock slide spring.
NOTE: The DSP77 spring does not have to be used, it is supplied in case the stock spring is misplaced. The Dynojet washer DW0001 does not need to be installed at this time, it is for half step adjustments. After installing the slides in the carbs, be sure to check slide movement manually before airbox installation.
3. Remove stock main jet and plastic main jet cup (Fig.B). Discard the plastic cup as it **WILL NOT** be reinstalled. Install the Dynojet main jet provided. Use the DJ155 below 3000 feet, DJ150 from 3000 to 6000 feet and DJ146 above 6000 feet. When using an aftermarket exhaust with a high flow baffle, use the DJ160 below 3000 feet, DJ155 from 3000 to 6000 feet and the DJ150 above 6000 feet.
4. Locate the Fuel Mixture Screw (Fig.B). **NOTE:** There may be a brass plug over the mixture screw. If so, with the plug drill DD 5/32 provided, carefully drill through the plugs. **NOTE:** The mixture screw is directly underneath this plug, be ready to pull back on the drill the instant you break through. Use the screw provided DS0001 to secure and remove the plug. Using a flat blade screwdriver, turn the mixture screw clockwise until it seats, then turn out 3 turns, 2.5 turns above 5000 feet.

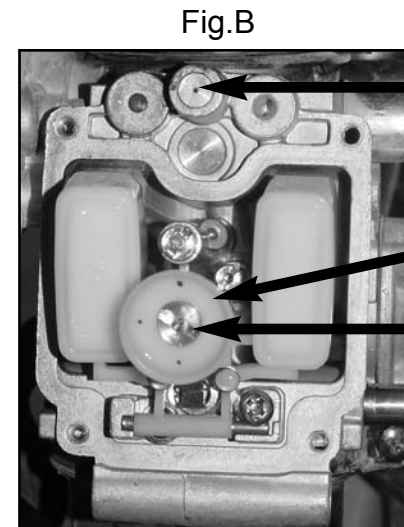
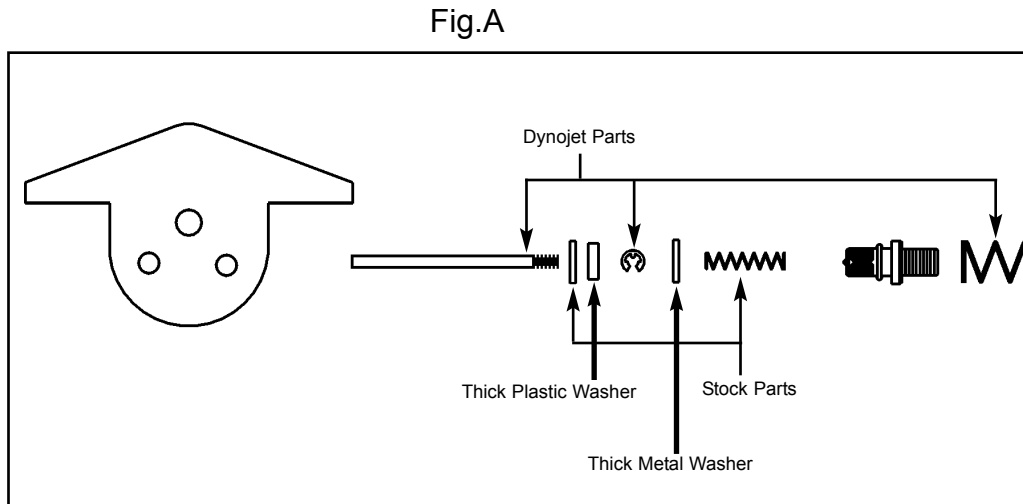
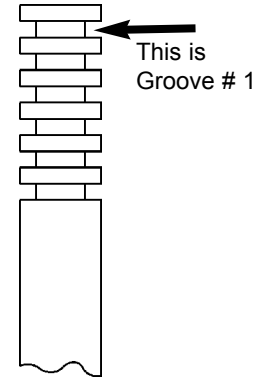

Mixture Screw Location. If there is a brass plug over the mixture screw, use the drill & screw provided to remove the plug.

The Main Jet cup is **NOT** used with this jet kit.

Main Jet Location